

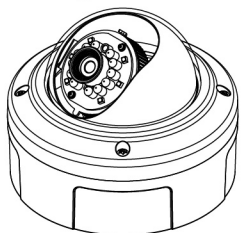

Vandal Dome Network Camera Hardware Installation

Package Contents



2Megapixel / IR
Fixed Lens

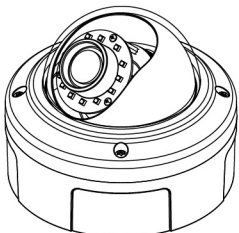

2/3Megapixel / IR
Vari-Focal Lens

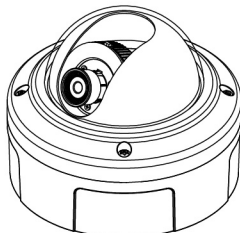

2/3/5Megapixel
Fixed Lens

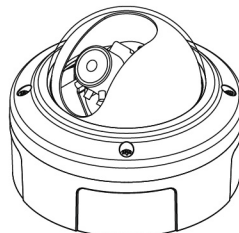

2/3Megapixel
Vari-Focal Lens

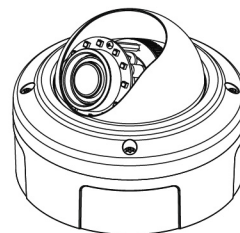

5Megapixel
Vari-Focal Lens

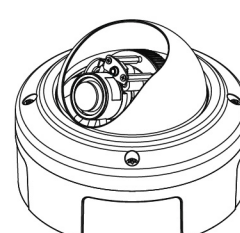

CCD

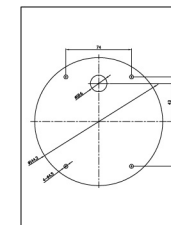

Mounting position sheet

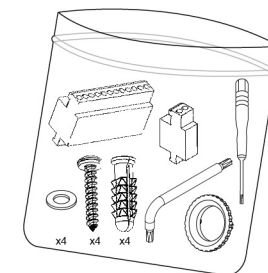

* As above assembly kit, it will be depended on the actual product spec of shipment.

1

Start the Installation

Use a hexagonal wrench to release the screw securing the cap.

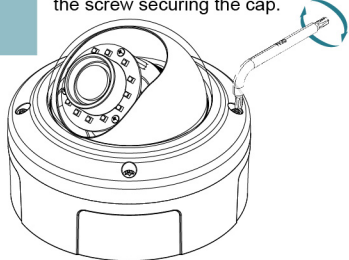

1-1

Remove the Cover

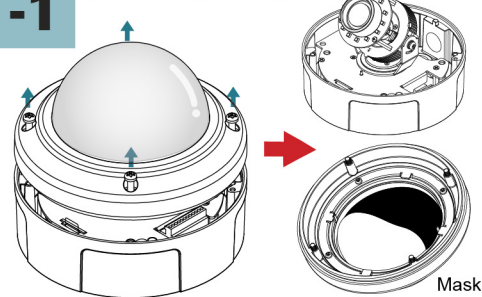

Mask

2

Lens Adjustment

Use the screw driver to relax the screws for lens angle adjustment.

* Lock the screws after the lens angle is adjusted.

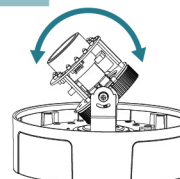

Tilting Coverage

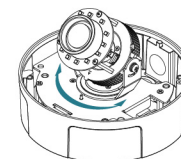

Panning Coverage

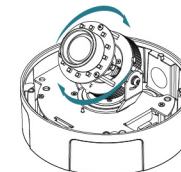

Z-axis

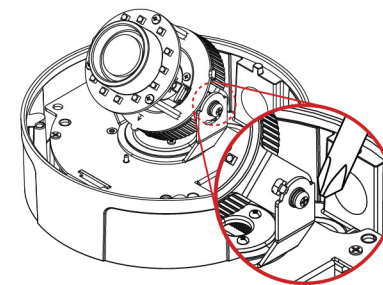

2-1

Vari-Focal Lens

* Available for 2/3Megapixel

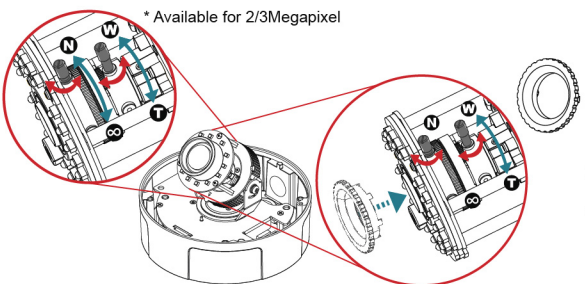
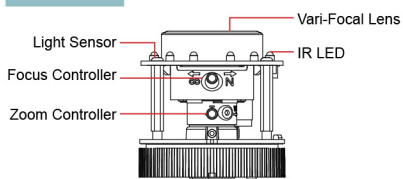

Focus Ring (Available for 5Megapixel)
Lens tool for adjusting focus.

1. Put it in front of the lens and turn it around to adjust focus.
2. Unscrew the focus ring to adjust the zoom setting as required.
3. Re-tighten the controller and remove the focus ring after the lens had been adjusted.

2-2

Fixed Lens

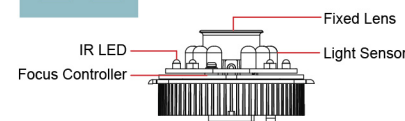

The focus of fixed lens had been set by factory. Release clockwise the controller of the focus and then twist the lens to adjust the focus if necessary.

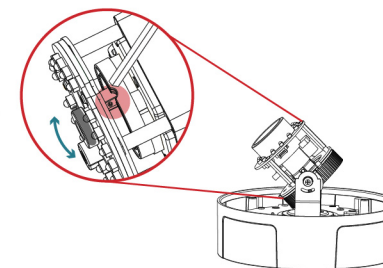

3

Making Connections

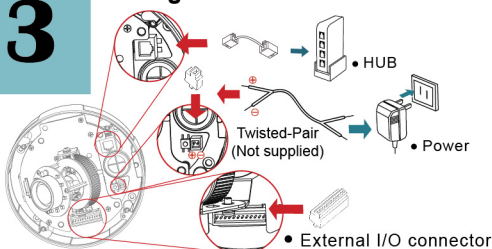

4

Smart cable management

Wrap the cable around the hook. There are 2 ways for you to manage the cables.

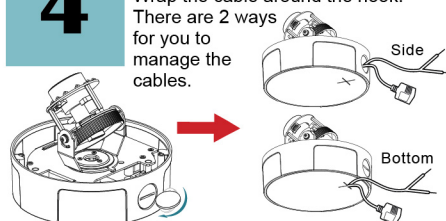

5

Mask Adjustment

Before mounting the camera, please adjust the appropriate position in accordance with the visual angle of the lens.

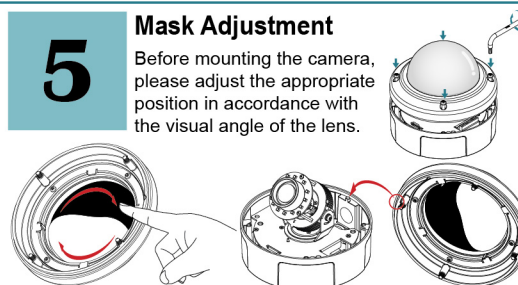

6

Tripod Mounting

Mounting the camera in accordance with mounting position sheet attached.

- On the wall
- On the ceiling

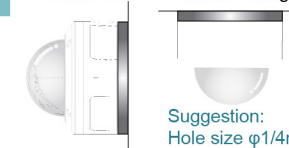

Suggestion:
Hole size ϕ 1/4mm, Depth 1inch

To use this product outdoors, it must be installed in an approved outdoor housing.



Vandal Dome Network Camera Connection Diagram

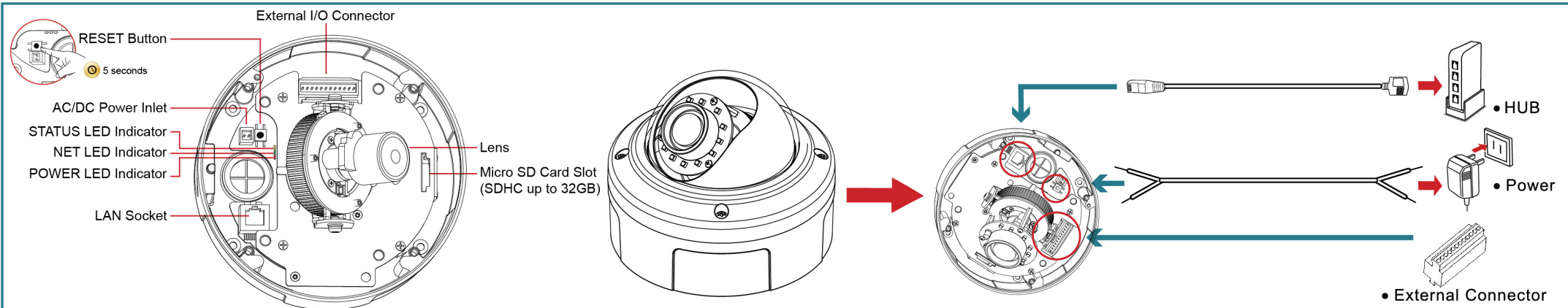

1. Some function will be different depending on the model.
 2. No SD/SDHC Card Slot & Local Storage Function apply for Argentina.

Connect the product to the switch hub and PC.

1 Connecting up

Prepare the product, your PC and switch hub ready for connection. Make sure that your PC has a LAN port available for connection to the network cable of the product.

2 Connect to the power outlet

Connect with your power adaptor directly using the twisted pair (not supplied) after plug the supplied 2pin connector into **J7** as shown.

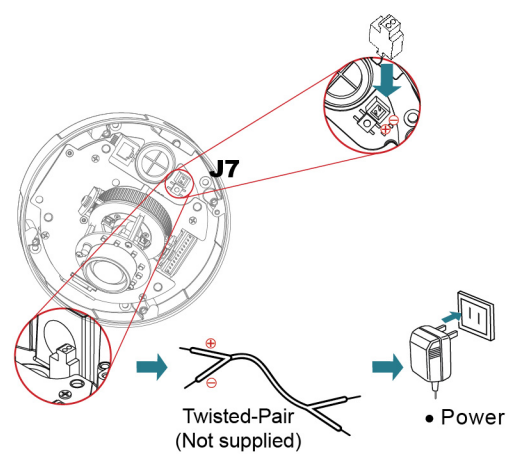

3 Connect the switch hub to your PC

Use a network cable and plug it in the LAN port of the product. Plug the other end of the cable in the LAN port of the hub.

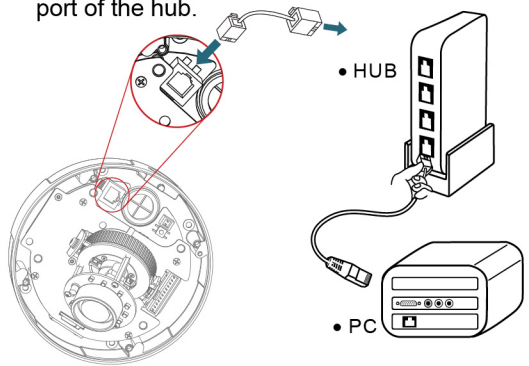

4 Plug the External I/O connector

Plug the supplied external I/O connector into **J8** as shown.

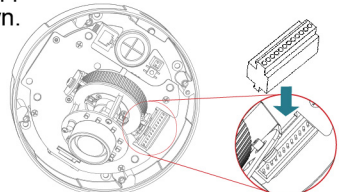

External I/O setting

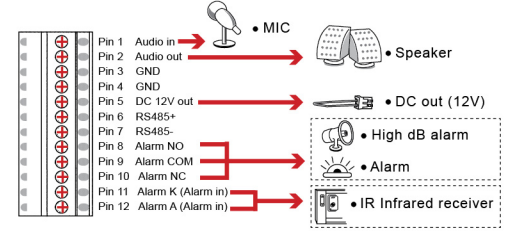

5 Turn on the power

Turn on the power of the PC and hub.

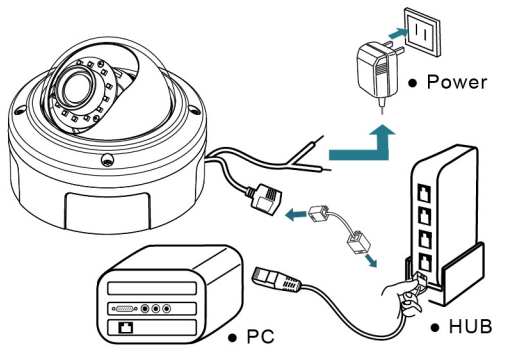

6 Getting Started

After you have finished install the network camera, please check if it is ready to use by the led indicator as below:

